

# BAY STATE COHOUSING

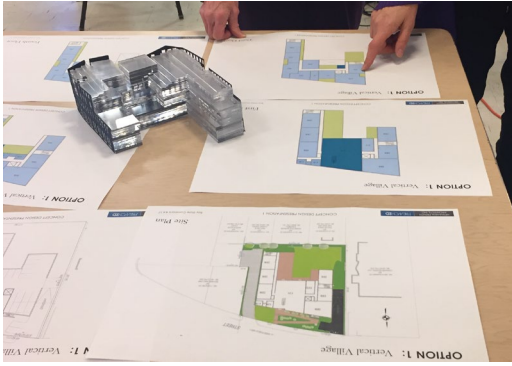

FRENCH 2D



### Studio

**ASSEMBLED PIECES:**

- (1) Small Bedroom (no wall) with (1) Medium Closet
- (1) Small Bathroom
- (1) Medium Kitchen
- (1) Medium Living Room
- (1) Small Closet
- (1) Small Entry Closer
- (1) Linen Closet

**ASSEMBLED NET SF:** 531  
**TARGET\* NET SF:** 525

**KEY ELEMENTS:** Open 'L' Shape Plan, Large kitchen area with seating, no additional dining area

**KEY RELATIONSHIPS:**  
 -assembled pieces could be accommodated in a double loaded corridor configuration (i.e. one window wall side) or floor through

### 3 BEDROOM LARGE

**ASSEMBLED PIECES:**

- (1) Large Bedroom with (1) Medium Closet
- (1) Medium Bedroom with (1) Small Closet
- (1) Medium Bedroom
- (1) Small Bathroom
- (1) Medium Bathroom
- (1) Half Bath
- (1) Small Linen Closet
- (1) Small Entry Closer
- (1) Large Kitchen
- (1) Large Dining Area
- (1) Medium Living Room
- (1) Small Living Room

**ASSEMBLED NET SF:** 1485  
**TARGET NET SF:** 1353

**KEY ELEMENTS:**  
 -living room, kitchen and dining very open, 2 level layout separating sleeping/living

**KEY RELATIONSHIPS:**  
 -layout can be accommodated in a double loaded corridor configuration (i.e. one window wall side) if the floor plate is shallow (i.e. thinner, longer building). Works well as a floor through



**CCP 554/2018 as Amended by Ordinance Committee on April 2 & April 9, 2019**

ORDER: TO AMEND CHAPTER 12, REVISED ORDINANCES OF 1991, BY ADDING SECTIONS 800.6.2, 300.3.2.13, 400.1.2.10 and 500.1.2.9 REGARDING CO-HOUSING

By amending Section 800 ADMINISTRATION By adding the following definition to Section 800.6.2.24

Dwelling, Cohousing A building containing a minimum total of ten (10) dwelling units but a maximum of no more than thirty-five (35) dwelling units (each dwelling unit containing no more than three (3) bedrooms) used and occupied by, an association of residents, which association shall be established and maintained in accordance with a legally binding written agreement, a copy of which shall be submitted to the City Building Commissioner, that shall include shared kitchen and dining facilities, and continuous indoor and open space areas of sufficient size to accommodate assembly of the majority of the residents, and all interior shared spaces combined shall comprise a minimum total of fifteen percent (15%) of the entire gross floor area of the building, exclusive of corridors and parking.

By amending Section 300 USE REGULATIONS by adding Section 300.3.2.13:

Section Number	Use	A	B	C	RO	BN	B C	BH	I1	I2
300. 3.2.13	Dwelling, Cohousing	No	No	No	SP	No	N o	No	No	No

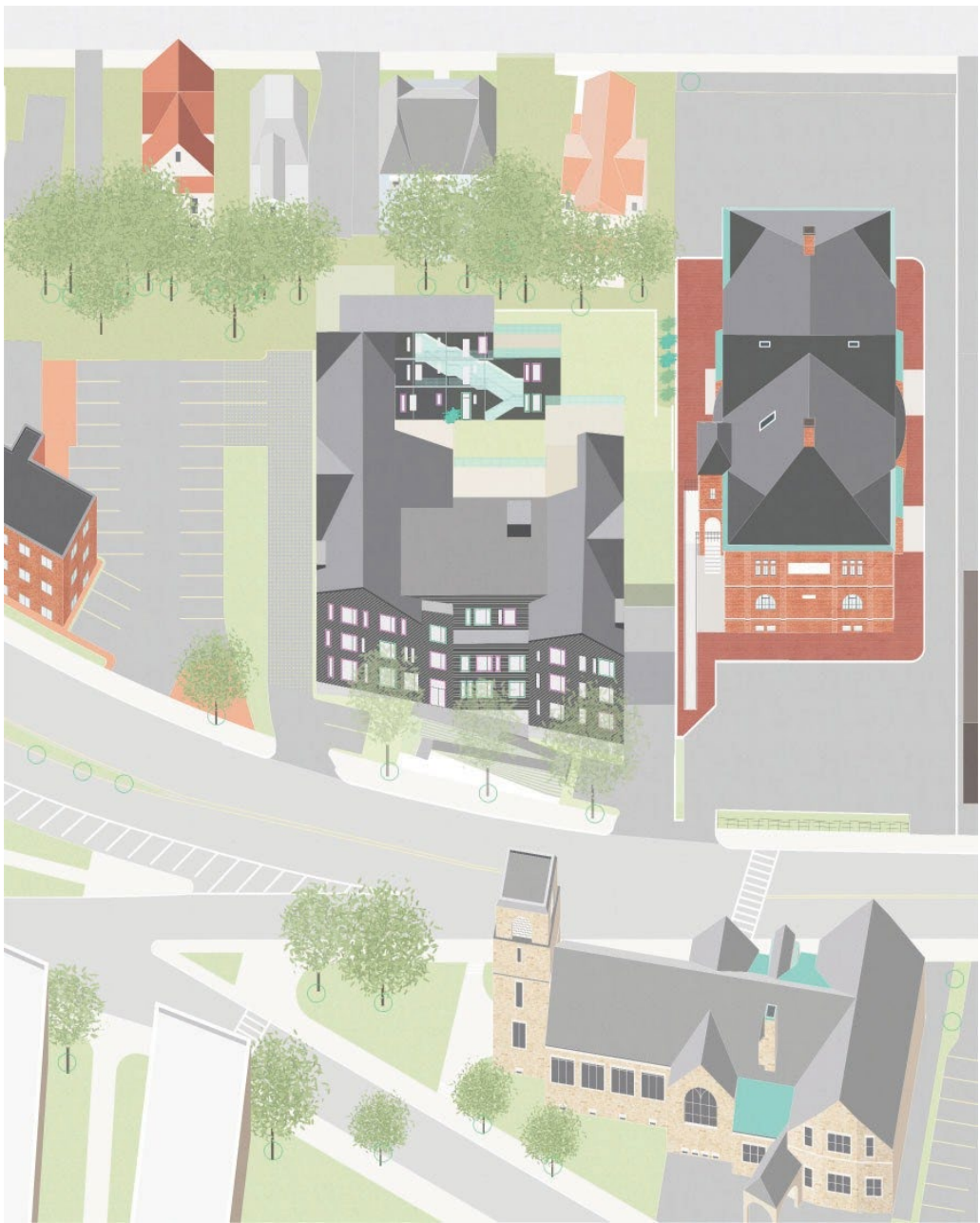

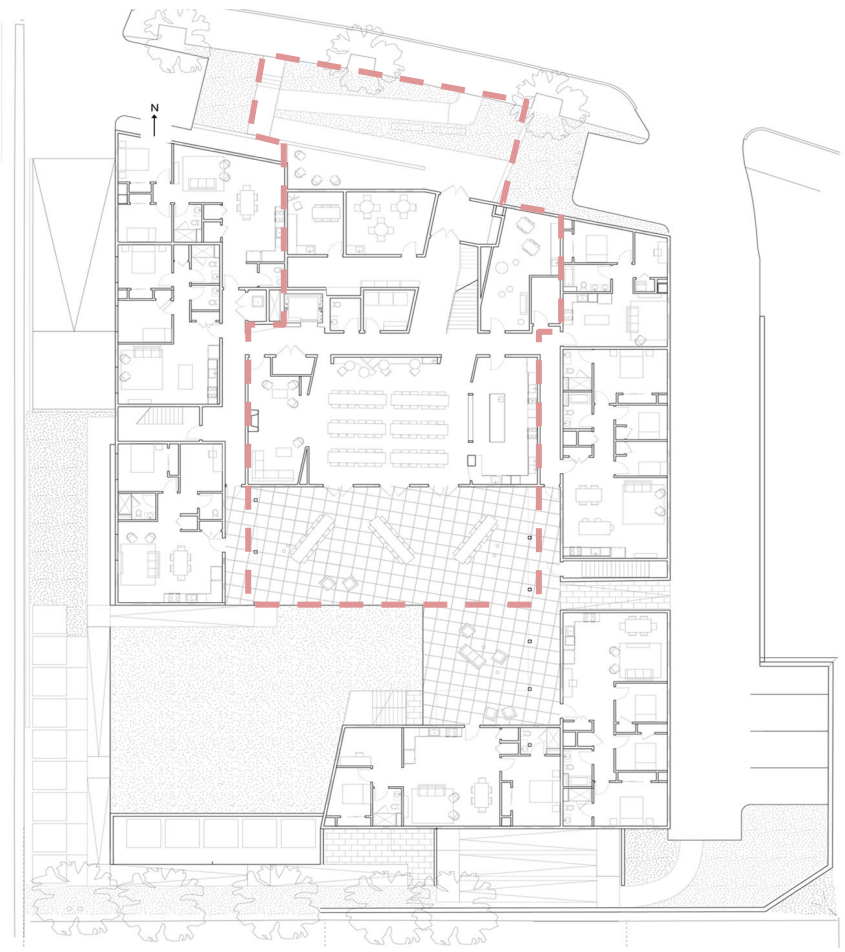

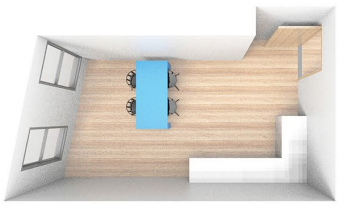
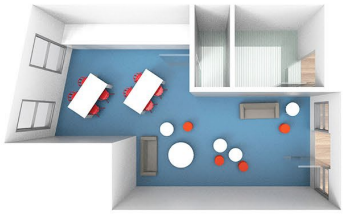
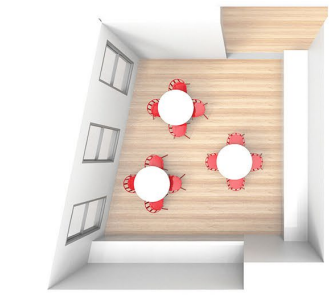
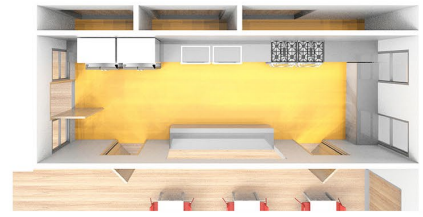
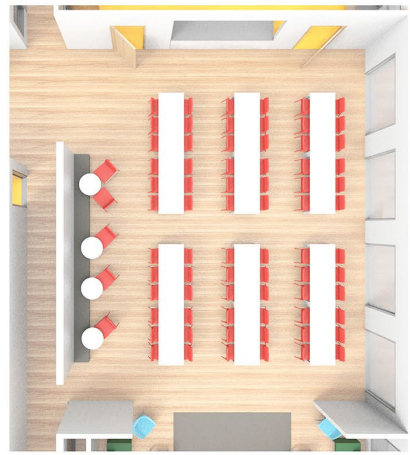
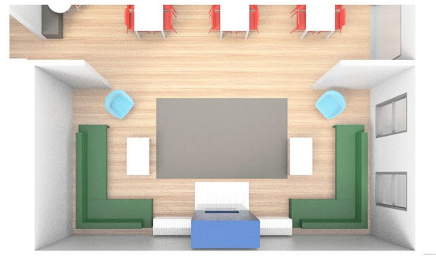

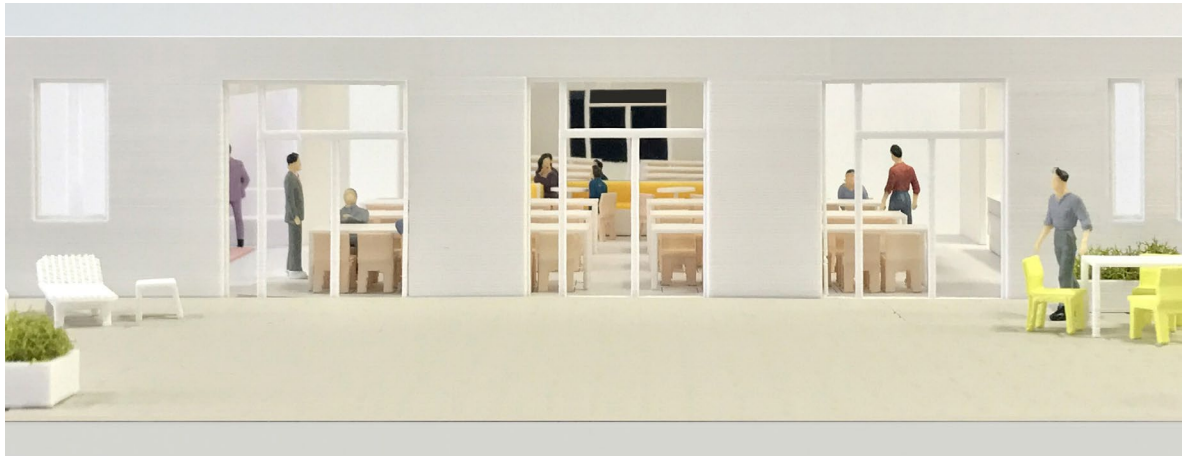

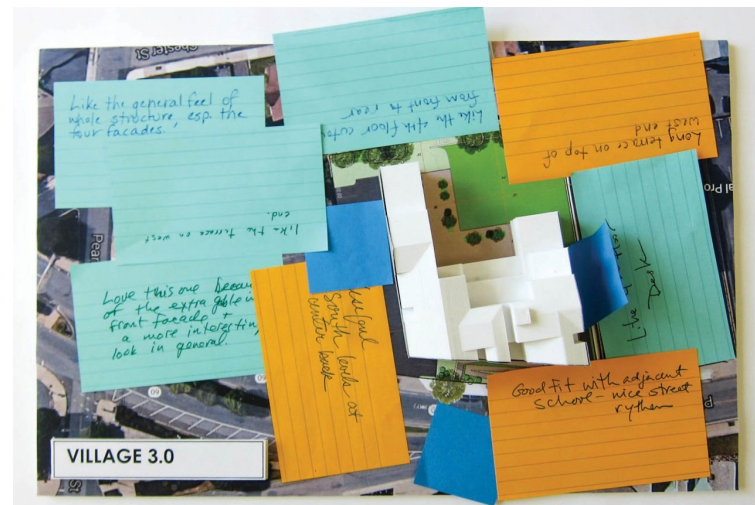
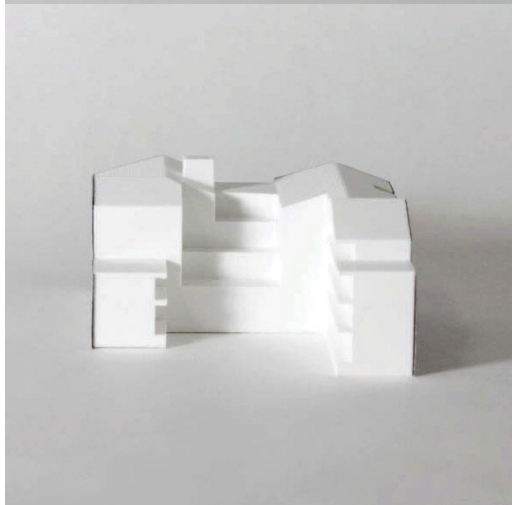
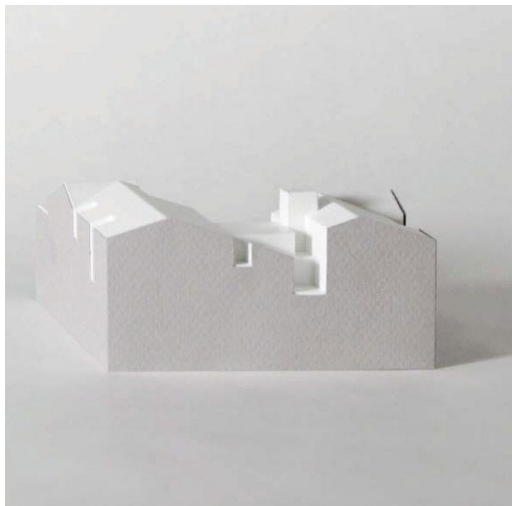
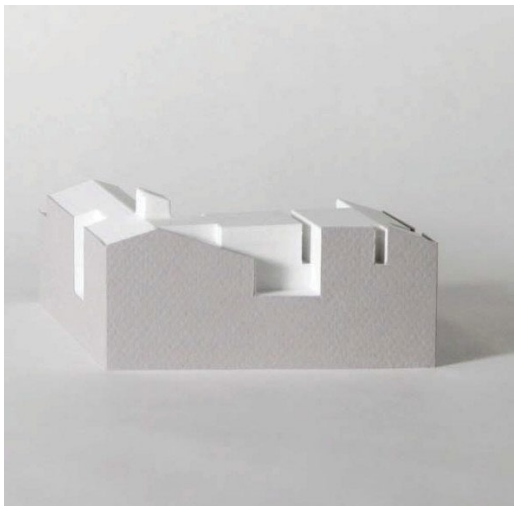

VILLAGE 3.0



DUTCH VILLAGE

